

Touchless Solutions

No touch. No compromise.



Roca

The EM1 Touchless dual flush valve

Zero contact Maximum hygiene

Wave goodbye to germ-ridden flush buttons

A touchless transformation

The EM1 valve can be simply retrofitted to upgrade an existing push button to an automatic toilet flush button.

Ease of installation

Quick and easy to install with minimal effort.

No electric connection needed

Powered by 4 AA batteries (not included) that guarantee more than 40,000 flushes.

Easy to use

With just a simple wave of the hand. The EM1 recognises the required flush (full or half flush volumes).

Water saving

Full and half flushes can be adjusted easily to 6/4, 4.5/3 or 4/2 litre dual flush settings.

Touchless hygienic flushing

With a sleek designed sensor push button, you can flush your WC in a hygienic way.

Full or half flush

Quick install

Allows the transformation of conventional push button cisterns into touchless ones with minimal effort.

Nothing touches the EM1 for features

EM1

Touchless dual flush universal mechanism

Ref. 822599900 - £106.80

TOUCHLESS

Touchless - Hygiene

The flush activates without contact thanks to an integrated infrared sensor, avoiding the spreading of viruses and the growth of bacteria.

No electrical installation

It works on 4 AA batteries (not included) that guarantee more than 40,000 flushes.

Manual battery back-up

It also works manually if the batteries run out.

Adjustable dual flush

Full and half flush volumes to be adjusted between 2 and 6 litres.

The dual flush valve body has WRAS approval.

Universal

Compatible with most cisterns with a ø40mm cistern hole and an external cistern height (with cistern lid) of 360-390mm.

Wave hand
Half flush
3/2 litres

1

Still hand
Full flush
6/4, 5/4 litres

Quick install

Quick assembly and activation.

Dimensions

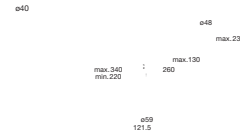

Installation

Scan the QR code to watch an installation video or visit www.uk.roca.com for installation instructions and further product information.

1

2

3

4

Prices shown are recommended retail prices including VAT.

3

2

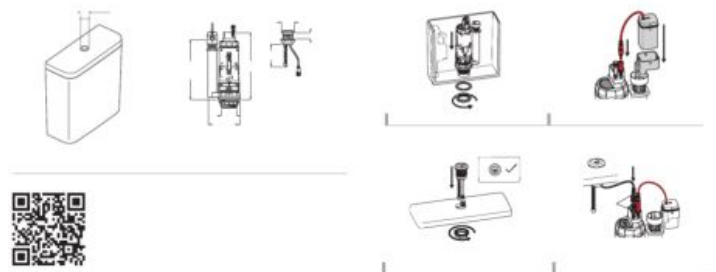

Touchless innovation from Roca

Roca's Touchless solutions are suitable for both domestic and commercial use, providing an extra layer of safety within the bathroom. Featuring infrared sensors, touchless products allow users to activate the water flow in taps, the flush of the WC or the mirror light using a simple movement without the need for contact, avoiding the spreading of viruses and the growth of bacteria.

More hygiene

Its infrared sensor activates the water flow when presence is detected, avoiding direct hand contact.

More savings

The water flow is automatically shut off when the infrared sensor stops detecting presence, preventing the unnecessary waste of water.

Durability

The power supply by four 1.5 V LR6 (AA) alkaline batteries guarantees over 250,000 uses.

Easy cleaning

The lack of contact with the tap improves hygiene and prevents the build up of droplets and fingerprints on its surface, resulting in a cleaner product for much longer.

Easy installation

Its battery or mains operated system allows its installation in any bathroom, regardless of the availability of a power outlet in the area of usage.

Anti-vandal

Its one-piece design, without a lever, ensures the integrity of the product and prevents its theft in public spaces.

Greater safety

Its electronic device stops the water flow after a preset usage time to promote a moderate use and prevent the uninterrupted flow of water.

L20-E

M3-E

Electronic basin mixers

EverSense®

Loft-E Electronic basin mixer

238	152
-----	-----

SA243C00 Battery powered*	£420.06
SA343C00 Mains powered*	£482.07
Optional: 001224567 Thermostatic mixing valve 1	£113.58

Loft-E Extended electronic basin mixer

6.0 mm	338	251
--------	-----	-----

SA314C00 Battery powered*	£420.06
SA394C00 Mains powered*	£482.07
Optional: 001224567 Thermostatic mixing valve 1	£113.58

Loft-E Wall-mounted electronic basin mixer

6.0 mm	59	203
--------	----	-----

SA594C00 Battery powered*	£448.07
SA574C00 Mains powered*	£490.08
Optional: 001224567 Thermostatic mixing valve 1	£113.58

L90-E Electronic basin mixer

5.7 mm	114	165
--------	-----	-----

8 l/min	SA530C00 Battery powered, External temperature control	£721.99
	SA550C00 Mains powered, External temperature control	£805.94
	SA560C00 Battery powered*	£679.12
	SA570C00 Mains powered*	£721.13
Optional: 001224567 Thermostatic mixing valve 1		£113.58

M3-E Electronic basin mixer

5.7 mm	137	84
--------	-----	----

SA330C00 Battery powered	£720.42
SA530C00 Mains powered	£792.16
SA560C00 Battery powered*	£686.11
SA570C00 Mains powered*	£784.13
Optional: 001224567 Thermostatic mixing valve 1	£113.58

L20-E Electronic basin mixer

5.0 mm	128.4	102.7
--------	-------	-------

SA503C00 Battery powered*	£350.06
SA570C00 Mains powered*	£385.07
Optional: 001224567 Thermostatic mixing valve 1	£113.58

* Please note to achieve a preset water temperature, a thermostatic mixing valve is required to mix the hot and cold water supplies. Prices shown are recommended retail prices including VAT.

1 WRAS approved product

5

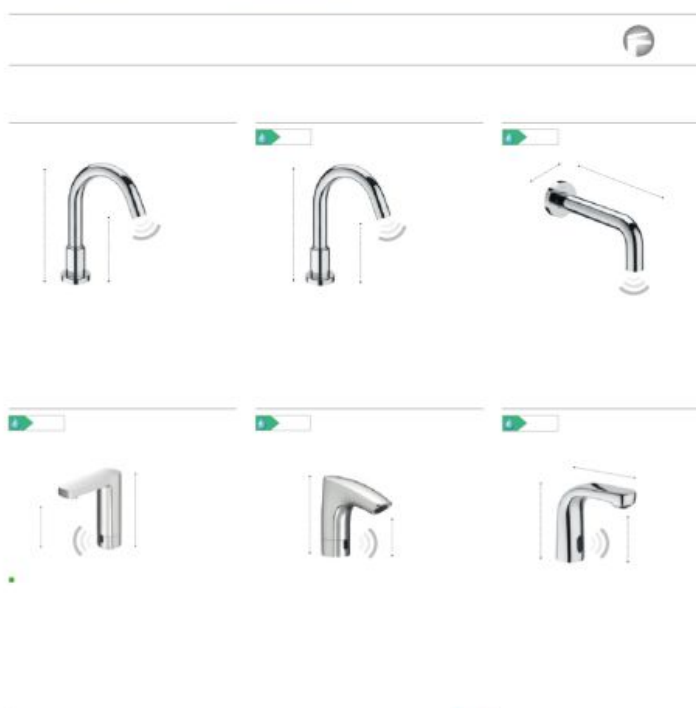

Mirrors with LED lights

Prisma Comfort

A

800

A 1300 1200 1100 1000 900 800 600

812277000	1300 x 800mm	£926.82
812288000	1200 x 800mm	£842.55
812287000	1100 x 800mm	£747.90
812286000	1000 x 800mm	£718.63
812285000	900 x 800mm	£689.36
812284000	800 x 800mm	£351.06
812283000	600 x 800mm	£12.76

Please note the Prisma mirrors require mains connections. Comfort LED mirrors feature upper and lower LED lights, a demister and an automatic sensor. Landscape installation only.

Prisma

EP-1

Operating panels

M3-E

EP-1 Electronic - Dual flush

250

EP-2 Electronic - Dual flush

250

160

160

Prisma

Prisma

89010008	Standard - black glass finish	£910.15	89010009	Standard - white finish	£910.15
89010008	Compact - black glass finish	£910.15	89010009	Compact - white finish	£910.15

Roca withhold the right to withdraw products and amend prices at any time, prices shown are recommended retail prices including VAT. Images used are for illustrative purposes only. For full technical specifications please visit our website www.uk.roca.com to download technical drawings, view installation videos and installation manuals. Dimensions are in mm, due to manufacturing processes all dimensions are approximate. Roca Ltd. has made every effort to ensure that the information provided within this brochure is accurate, however Roca Ltd cannot guarantee this and accepts no liability for any information printed within this brochure. The information in this brochure is intended as a guide to help you decide on the best products for your space and budget. It is not intended to be a substitute for guidance from bathroom professionals so it is always wise to check that the products you like are suitable for your installation.

EP-2

L20-E

EP-2





Roca Ltd

Interlink Way West, Bardon,
Coalville, Leicestershire, LE67 1LD
Tel: 01530 830 080
Fax: 01530 830 010
www.uk.roca.com

Roca Ireland

Unit 628A, Jordanstown Avenue,
Greenogue Industrial Estate,
Rathcoole,
County Dublin
Telephone: (01) 401 9340